



18 Chisholm Crescent Blaxland NSW

4 2 1

LOCATION - Tucked away in a peaceful and sought after pocket of Blaxland, enjoy the convenience of an approx. 300m stroll to local park, sports fields and gym, and a walk to local and Blaxland shops, school, bus, rail and the pub, all within approx. 1.6km.

STYLE - Lovingly maintained single level brick and tile home, with a family friendly layout on a beautiful and mostly level 738.6sqm block.

LAYOUT - 2 generous living rooms, encompassing the sunlit formal lounge and family room off the open plan kitchen, formal dining, 4 bedrooms all with built-in robes, primary with good sized ensuite, family bathroom with separate toilet, internal laundry with external access, 2 bathrooms overall.

FEATURES - Updated kitchen with natural gas cooking,

Type : House
Price : \$ 1,155,000
Land Size : 738.6 sqm
View : <https://www.chapmanrealestate.com.au/sale/nsw/blue-mountains-surrounds/blaxland/residential/house/7916952>

[For full version visit the website](https://www.chapmanrealestate.com.au)



Milton Player
02 4739 4311



Glen Power
02 4739 4311

18 CHISHOLM CRESCENT, BLAXLAND

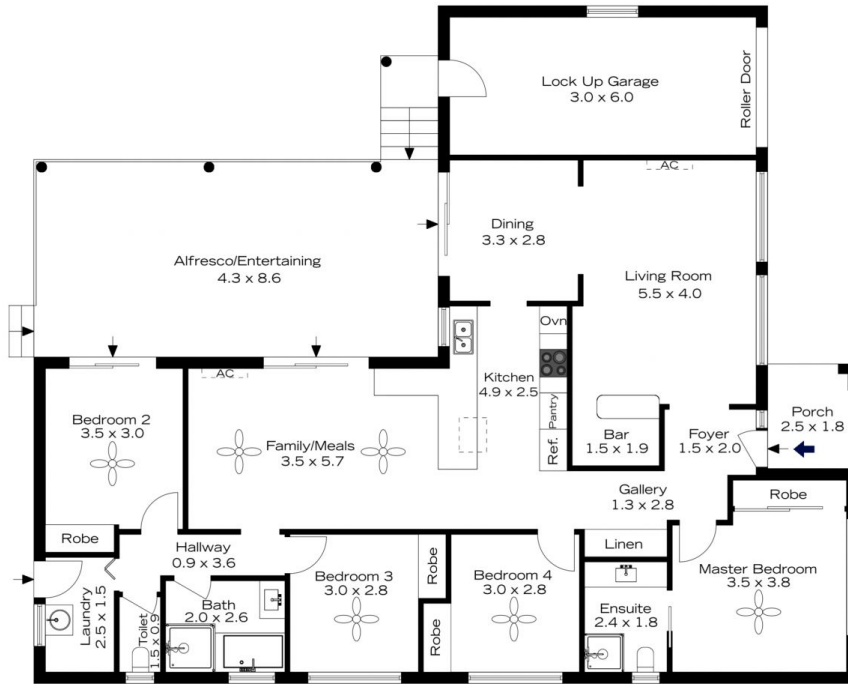

INTERNAL
162 m²

EXTERNAL
42 m²

TOTAL
204 m²



The floor plan is not to scale; measurements are indicative and in metres. Exterior elements are not in position. Plans should not be relied on. Interested parties should make and rely on their own enquiries.

18 CHISHOLM CRESCENT, BLAXLAND



INTERNAL
162 m²

EXTERNAL
42 m²

TOTAL
204 m²



The floor plan is not to scale; measurements are indicative and in metres. All features included in this 3D plan are for inspiration purposes only. This is not an exact replica of the property or the position of exterior elements. Plans should not be relied on. Interested parties should make and rely on their own enquiries.