



30 Second Avenue Katoomba NSW

4 2

LOCATION - Privately set in a quiet street on a gently sloping block with convenient access to the Train Station and Katoomba CBD. Being less than 1km to Katoomba North Public School and local bush walks, including Minnehaha Falls, this home is well positioned for serene mountains living.

STYLE - Traditionally identified as a Yurt, the hexagonal design of this 4 bedroom weatherboard home is captivatingly unique and with the high windows at the centre of the roof, the natural light and eyeline out to the sky is sensational.

LAYOUT - Well placed bedrooms to the right of the entry and living spaces to the left make the most of the full length windows that look out on to the wrap around rear deck and further out to the grassed and fully fenced backyard. The

Price : \$749,000 - \$779,000
Land Size : 1012 sqm
View : <https://www.chapmanrealestate.com.au/sale/nsw/blue-mountains-surrounds/katoomba/residential/house/7968134>

30 SECOND AVENUE, KATOOMBA



INTERNAL
111 m²

EXTERNAL
36 m²

TOTAL
147 m²



The floor plan is not to scale; measurements are indicative and in metres. All features included in this 3D plan are for inspiration purposes only. This is not an exact replica of the property or the position of exterior elements. Plans should not be relied on. Interested parties should make and rely on their own enquiries.

30 SECOND AVENUE, KATOOMBA

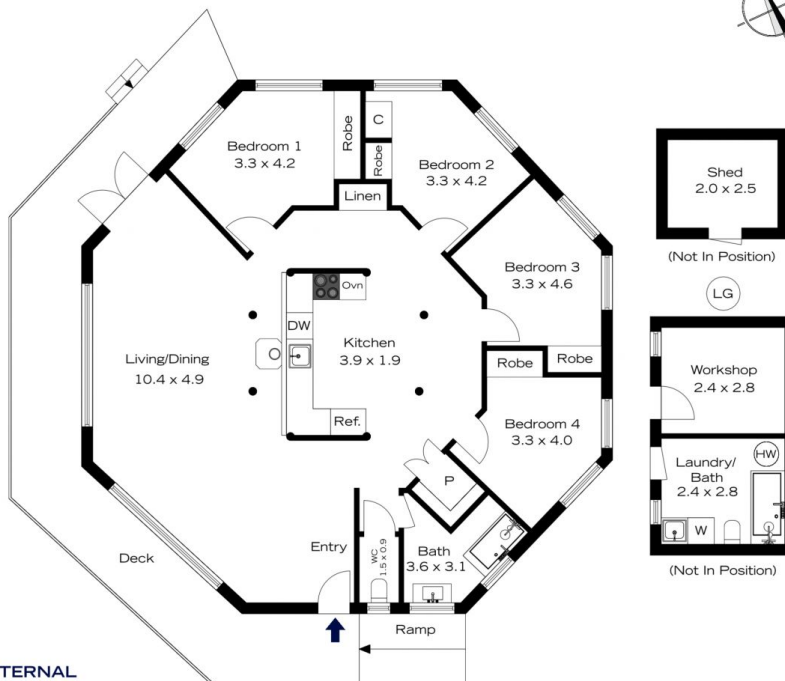

INTERNAL
111 m²

EXTERNAL
36 m²

TOTAL
147 m²



The floor plan is not to scale; measurements are indicative and in metres. Exterior elements are not in position. Plans should not be relied on. Interested parties should make and rely on their own enquiries.