

69 Bedford Road Woodford NSW

3 2

Location - Nestled in a serene setting, enjoying gorgeous bushland views offering unforgettable sunsets, and set amongst established landscaped lush gardens. Set within a community known for its friendly neighbours and peaceful surroundings. Take advantage of nearby amenities like bush walks, lush green parks, local cafe, bus and rail services and the historic Woodford Academy. Whether it's a scenic walk to Edith or Hazel Falls or tackling the iconic Oaks Trail by bike, this location is a nature-lover's dream.

Style - This delightful enchanting fully renovated brick residence offers the perfect blend of comfort and seclusion within a lush Mountain oasis. Immaculately presented, this split-level home offers a seamless blend of modern comfort and timeless charm. Every detail has been carefully

Type : House
Price : \$ 1,065,000
Land Size : 1014 sqm
View : <https://www.chapmanrealestate.com.au/sale/nsw/blue-mountains-surrounds/woodford/residential/house/8488661>



Milton Player
(02) 4739 4311

[For full version visit the website](https://www.chapmanrealestate.com.au)

<https://www.chapmanrealestate.com.au>

69 BEDFORD ROAD, WOODFORD



Ground Floor

INTERNAL
162 m²

EXTERNAL
69 m²

TOTAL
231 m²

The floor plan is not to scale; measurements are indicative and in metres. Exterior elements are not in position. Plans should not be relied on. Interested parties should make and rely on their own enquiries.

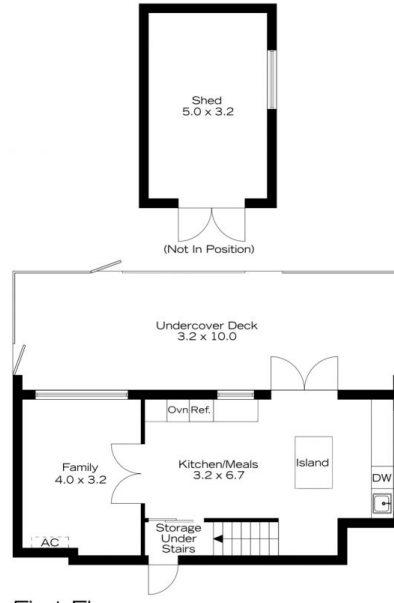

First Floor

69 BEDFORD ROAD, WOODFORD



Ground Floor

INTERNAL
162 m²

EXTERNAL
69 m²

TOTAL
231 m²

The floor plan is not to scale; measurements are indicative and in metres. All features included in this 3D plan are for inspiration purposes only. This is not an exact replica of the property or the position of exterior elements. Plans should not be relied on. Interested parties should make and rely on their own enquiries.



First Floor